

I:\26007\pwr\G1.1.dwg, 11/9/2006 9:51:31 AM, rthompson

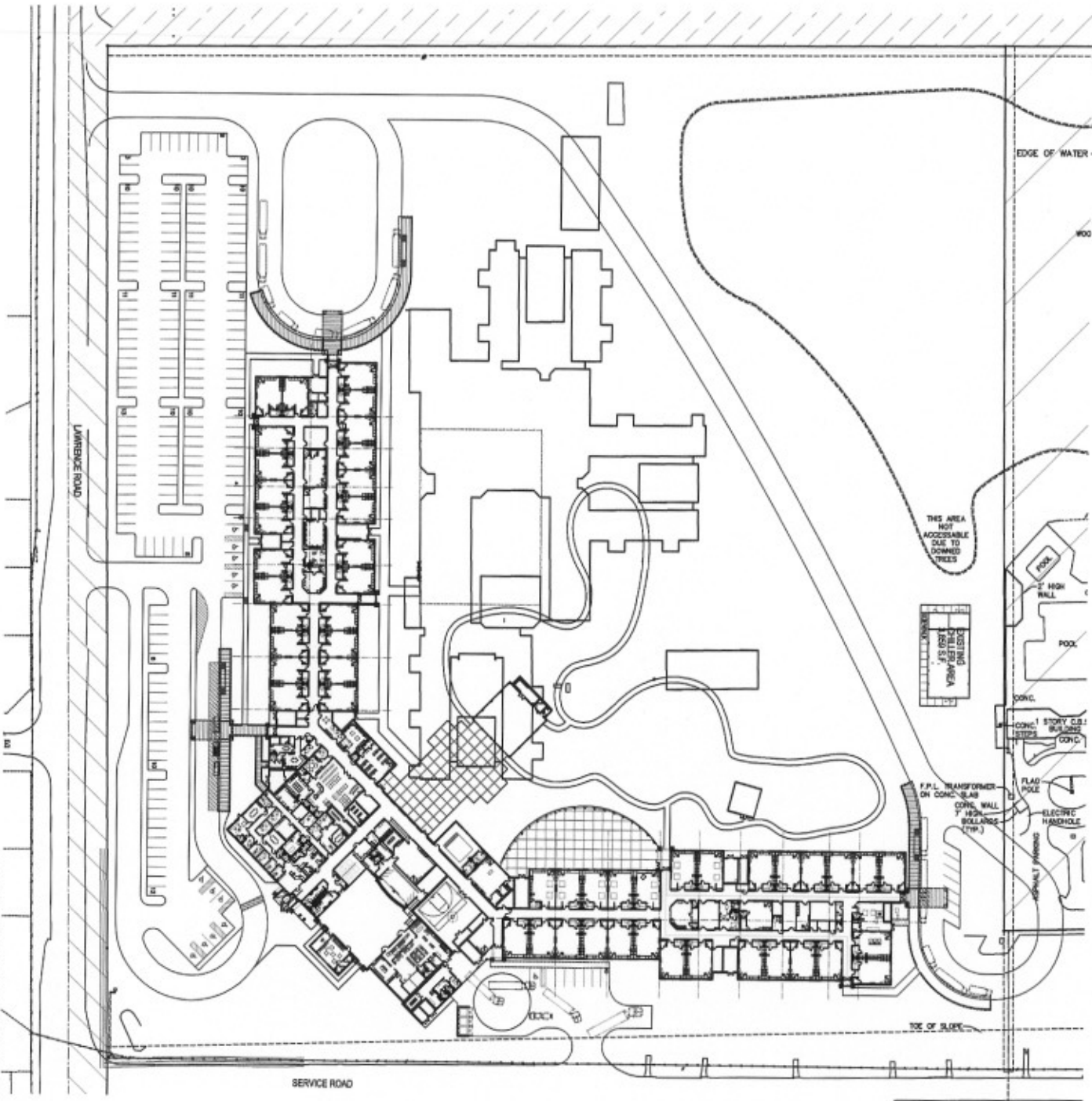

SITE TABULAR DATA
ROYAL PALM SCHOOL

PROPOSED STUDENT OCCUPANCY	886
SITE ACREAGE	22.17 ACRES
SITE AREA	966,888 S.F.
BUILDING #1	137,807 S.F. NEW ONE STORY PRE-K-12 BUILDING
BUILDING #2	3,816 S.F. NEW ONE STORY COVERED PLAY AREA
BUILDING #3	3,488 S.F. EXISTING ONE STORY OUTLER YARD
TOTAL GROSS AREA	145,111 S.F.
FLOOR AREA RATIO (FAR)	15.28 %
BUILDING COVERAGE	15.28 %
PROPOSED RETENTION SYSTEM	

NOTES:
ALL BUILDINGS ON THIS SITE ARE TO BE EQUIPPED WITH F.P.L. SIGNAGE THROUGHOUT. REFER TO THE ARCHITECTURAL PLANS FOR THE NAMES AND NUMBERS.

Surrounding Land Use:

North:
Zoning -
FLL -
Existing Land Use -

South:
Zoning -
FLL -
Existing Land Use -

East:
Zoning -
FLL -
Existing Land Use -

West:
Zoning -
FLL -
Existing Land Use -

TABULAR DATA

SECTION NUMBER	--
NAME OF PROJECT	ROYAL PALM SCHOOL
PROPOSED USE	PRE-K-12 SCHOOL WORKSHEET
FUTURE LAND USE DESIGNATION	--
ZONING DISTRICT	F2
SECTION/COMMISSION/PHASE	--
PROPERTY CONTROL NO.	--
TOTAL GROSS AREA OF	22,171,968.00 S.F.
STUDENT STATIONS	433
TOTAL EXISTING S.F.	3,488
TOTAL PROPOSED NEW S.F.	141,623
FLOOR AREA RATIO (FAR)	15.28 %
BUILDING COVERAGE	15.28 %
BUILDING HEIGHT (MAX)	27'-0"
NO. OF STOREY FLOORS	1
FINISHED GRADE ELEVATION	FF-

PARKING TABULATION (EXISTING)

SPIC	
# PER PARKING STATION	187
VEHICLES	8
NO. PARKING	12
TOTAL	207
PROVIDED PER 100 SPIC	

CONCURRENCY APPROVAL NOTATION PLAN

PRE-K - 12 SCHOOL	141,623 S.F. / 886 STUDENTS
-------------------	-----------------------------

tercilla *courtemanche*
ARCHITECTS
A.S. 0000000
3942 West Palm Beach, Florida 33411 Tel: 561.476.4407 Fax: 561.476.4180

Replacement School for:
ROYAL PALM SCHOOL
SOPAC Project No. 1801-0307
The School District of Palm Beach County
Lantana, Florida

consultation 26007
date 09-26-06
revision 001
no.
drawing **G1.1**
copyright 2006

NOT FOR CONSTRUCTION

PROPOSED SITE PLAN



2:136607.dwg(G1.1.dwg), 11/9/2006 9:52:47 AM, rthompson

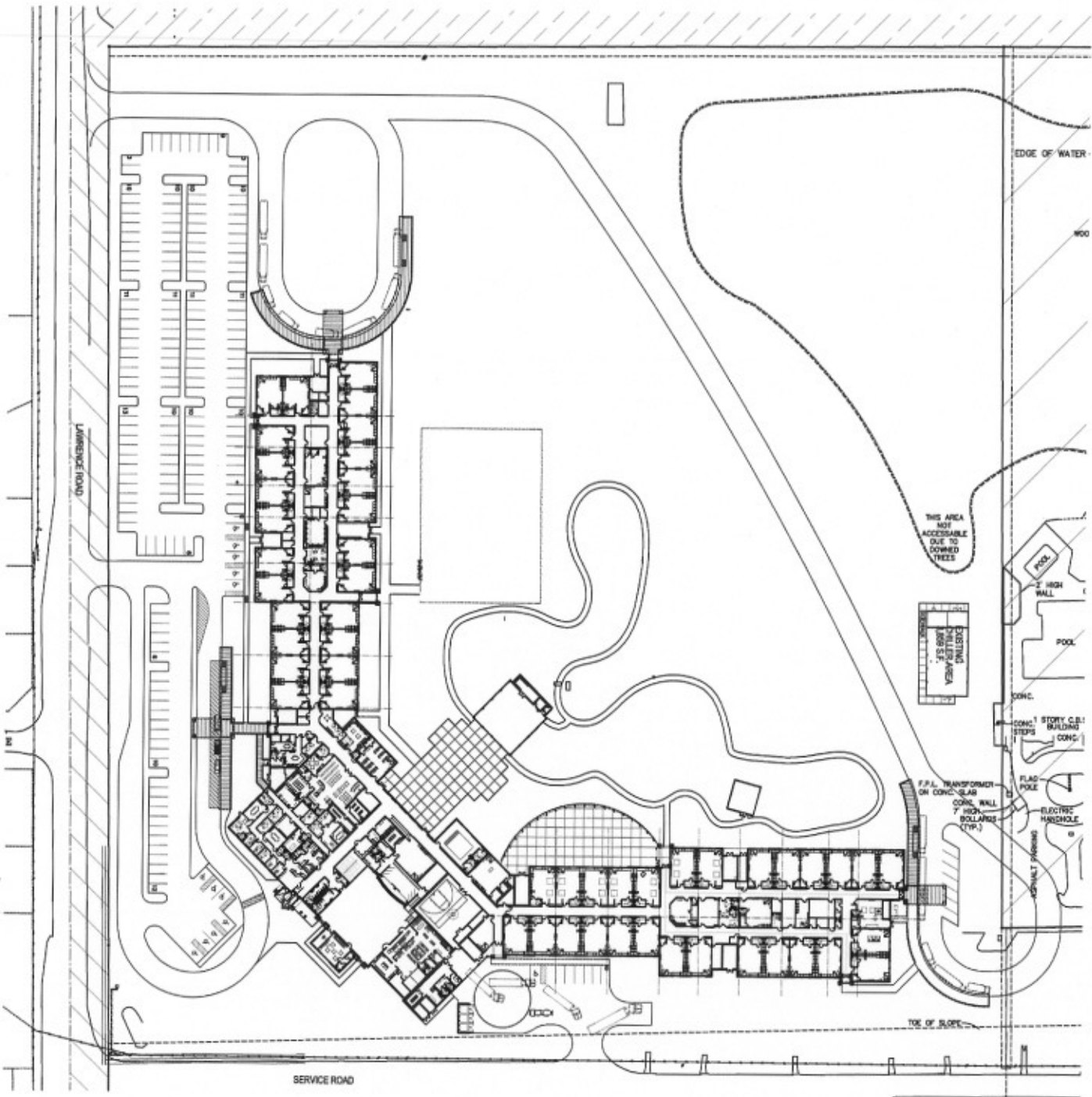

SITE TABULAR DATA
ROYAL PALM SCHOOL

PROPOSED STUDENT OCCUPANCY	888
SITE ADDRESS	32.17 ACRES
SITE AREA	881,528 S.F.
BUILDING # 1	137,887 S.F. NEW ONE STORY PRE-K-2 BUILDING
BUILDING # 2	3,816 S.F. NEW ONE STORY COVERED PLAY AREA
BUILDING # 3	3,486 S.F. EXISTING ONE STORY CHILLER HALL
TOTAL GROSS AREA	144,179 S.F.
FLOOR AREA RATIO (FAR)	15.28 %
BUILDING COVERAGE	15.28 %
PROPOSED RETENTION SYSTEM	

NOTE:
ALL BUILDINGS ON THIS SITE ARE TO BE EQUIPPED WITH F.U.E. STORAGE THROUGHOUT.
REFER TO THE ARCHITECTURAL PLANS FOR THE ISSUES AND REMARKS.

- Surrounding Land Use
- North
- Drivg -
 - F.U.C. -
 - Existing Land Use -
- South
- Drivg -
 - F.U.C. -
 - Existing Land Use -
- East
- Drivg -
 - F.U.C. -
 - Existing Land Use -
- West
- Drivg -
 - F.U.C. -
 - Existing Land Use -

TABULAR DATA

PETITION NUMBER	--
NAME OF PROJECT	ROYAL PALM SCHOOL
PROPOSED USE	PRE-K-12 SCHOOL MODERNIZATION
FUTURE LAND USE DESCRIPTION	--
ZONING DISTRICT	P-1
SECTION/TOWNSHIP/RANGE	--
PROPERTY CONTROL NO.	--
TOTAL GROSS ACRES/ACRE FT.	32.17 / 881,528 S.F.
STUDENT SEATING	420
TOTAL EXISTING S.F.	3,486
TOTAL PROPOSED NEW S.F.	140,693
FLOOR AREA RATIO (FAR)	15.28 %
BUILDING COVERAGE	15.28 %
BUILDING HEIGHT (MAX)	27'-0"
NO. OF STORIES/FLOORS	1
FINISHED GRADE ELEVATION	77'-0"

PARKING TABULATION (EXISTING)

TYPE	
3 PER 100 (FUTURE)	157
1 PER 100 (STAFF)	8
NO. PARKING	12
TOTAL	367
PROVIDED PER 100 (FUTURE)	

CONCURRENCY APPROVAL NOTATION PLAN

PRE-K-12 SCHOOL	144,673 S.F. / 888 STUDENTS
-----------------	-----------------------------



tercilla couryemanche
architects
A.S. 0000044
2045 S. W. 10th Street, Suite 100
West Palm Beach, Florida 33411 ph: 561.834.8457 fax: 561.876.1822

Replacement School for:
ROYAL PALM SCHOOL
SOPAC Project No. 1801-8307
The School District of Palm Beach County
Lantana, Florida

commission 26037
date 09-24-06
revision date
by
check
approved
drawing
G1.1
copyright 2006

NOT FOR CONSTRUCTION

PROPOSED SITE PLAN